



**HUTCHINSON,
MOORE &
RAUCH, LLC**

Engineers ♦ Surveyors ♦ Land Planners

Our Company

Established in April 2000, Hutchinson, Moore & Rauch, LLC (HMR) provides engineering, surveying, and construction services throughout Alabama, Mississippi and the Florida Gulf Coast.

Our goal is to remain consistent in our efforts to deliver results that exceed our client's expectations by utilizing the most cost effective, resourceful, and expeditious means available.

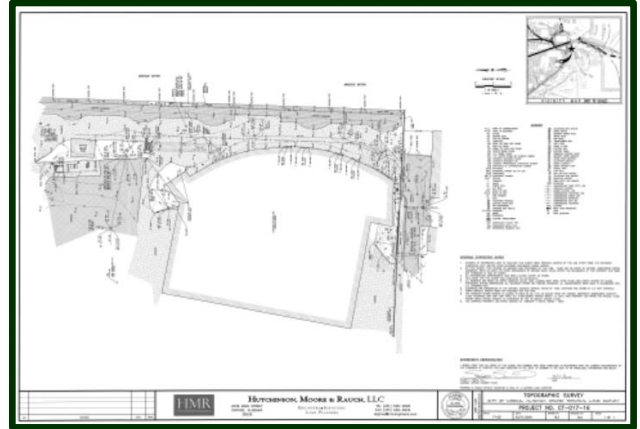
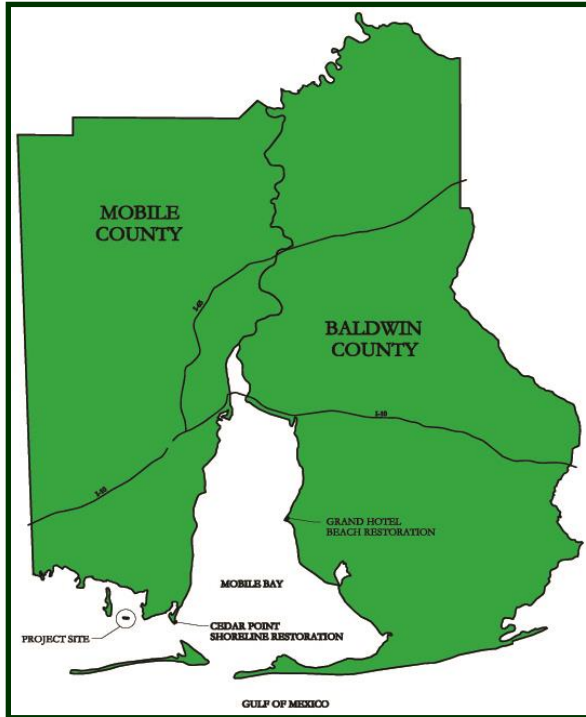

HMR is an established and respected engineering firm located on the Gulf Coast with a growing staff of professionals ready to meet the needs of any project. HMR has continued to expand services in the Mississippi and Florida Gulf Coast region. Our offices are located in Mobile, Daphne, and Foley, Alabama. Our experience enables us to provide our clients with quality services, value and customer satisfaction.

Our long-standing affiliations with other industry related professionals enables HMR to collaborate and enhance its scope of services in order to create customized projects to meet the specific needs of each client. We will continue looking for innovative ways to expand our services through partnerships or cutting edge industry related technologies.

Our firm maintains an outstanding reputation by focusing on quality of service, client satisfaction and overall total project success. Much of our business comes from repeat clients who maintain confidence in the HMR team because they trust that their project needs will receive prompt, careful and professional attention. HMR always welcomes new clients and projects allowing us to demonstrate our talents and commitment to client satisfaction. HMR services include:



- **Civil Engineering**
- **Land Surveys**
- **Hydrographic Surveys**
- **Construction Surveys**
- **Transportation Consulting**
- **Disaster Preparedness, Response & Recovery Services**
- **Environmental Site Assessment and Permits**
- **Water and Wastewater Planning and Design**
- **Construction Inspection and Surveillance**

